

4/15 Base

The 4/15 Base is the essential starting point for these color change models, requiring a precise fold 4/15 away from the edge. Because Step 5 can be hard to perform precisely, you can follow Steps 6a-6f to increase the precision by a factor of 16. Alternatively, you can even skip straight from Step 1 to Step 6a1, estimating 4/15 and improving the accuracy of your estimate.

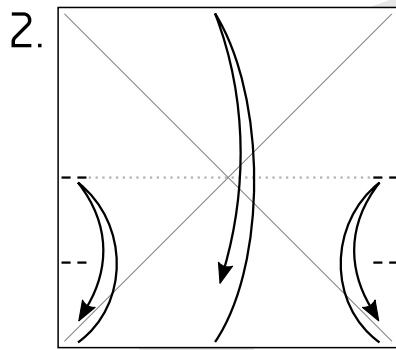

Pinch twice at both the left and right edges.

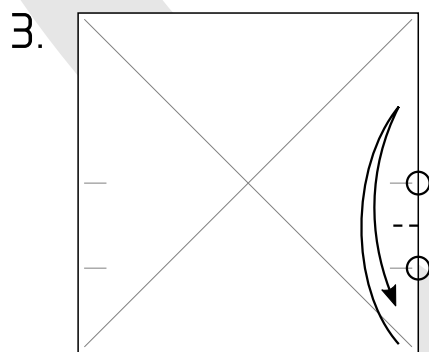

Bring the circled points together and pinch.

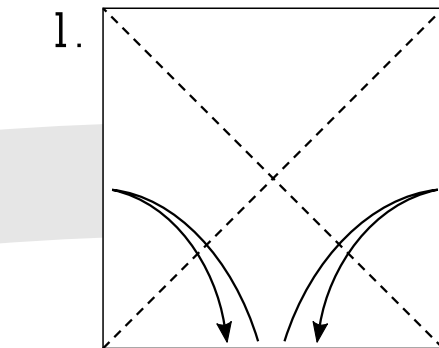

1.

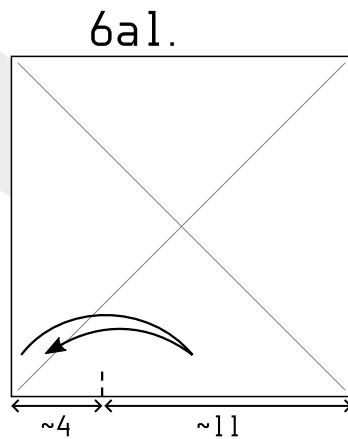

6a1.

Estimate 4/15 and pinch

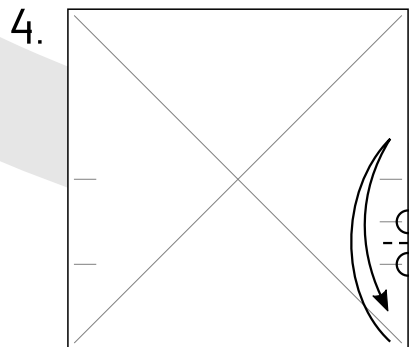

4.

Bring the circled points together and pinch.

Requires estimating

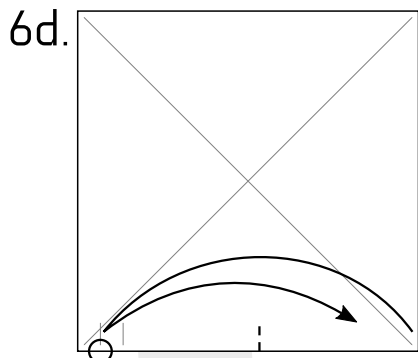

6d. Bring the corner to the circled point and pinch.

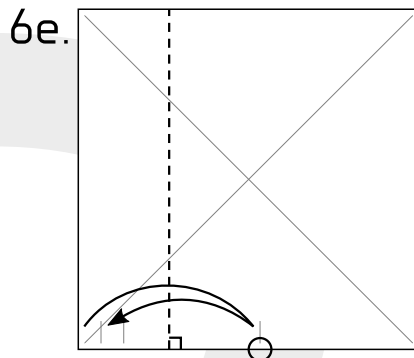

6e. Fold the corner to the circled point and unfold. The pinches will no longer be shown.

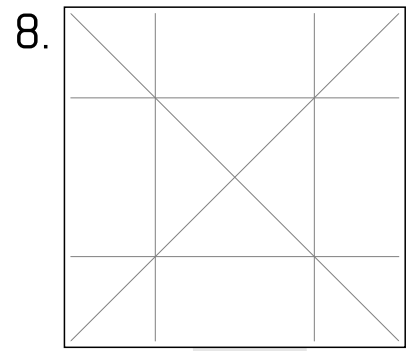

Base complete!

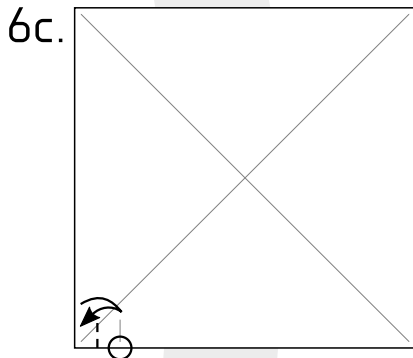

6c. Bring the corner to the circled point and pinch.

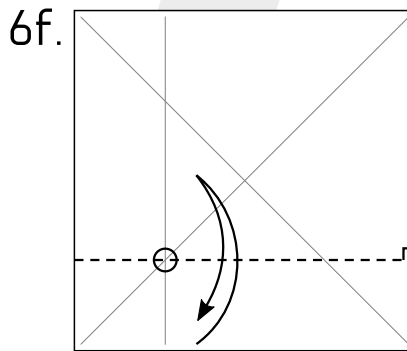

6f.

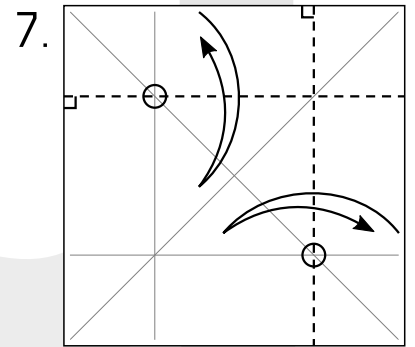

7.

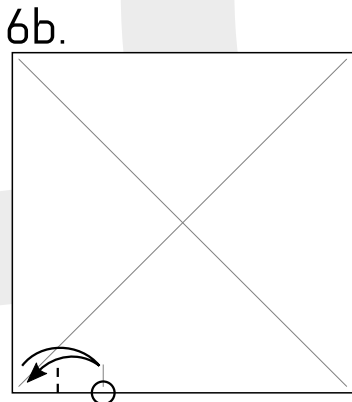

6b. Bring the corner to the circled point and pinch. The old pinch will no longer be shown.

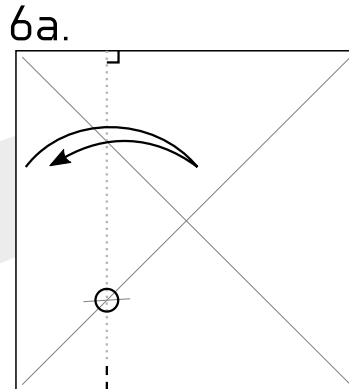

6a. Pinch at the bottom edge, using the pinch made in Step 5 [which will no longer be shown].

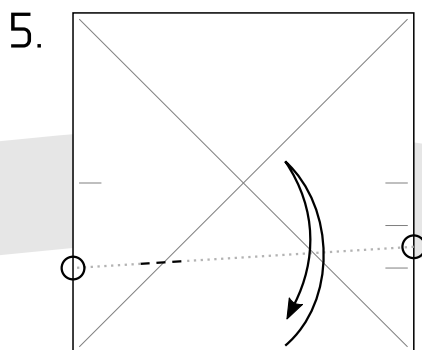

5. Pinch at the crease. The pinches will no longer be shown.

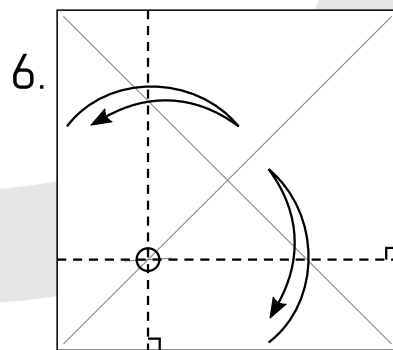

6. Crease at the pinch made in Step 5 [which will no longer be shown].

More precision

Quicker